

# USP90-ER16 Ultrasonic Spindle Motor

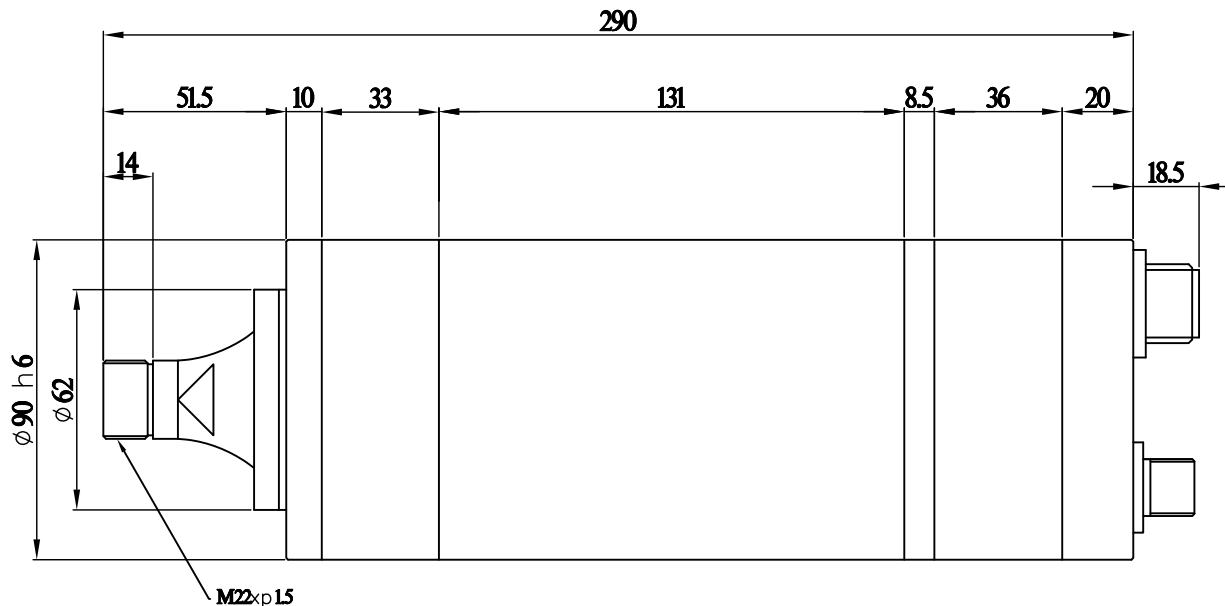

pin1-U  
pin2-V  
pin3-W  
pin4  
pin5  
pin6-Ground

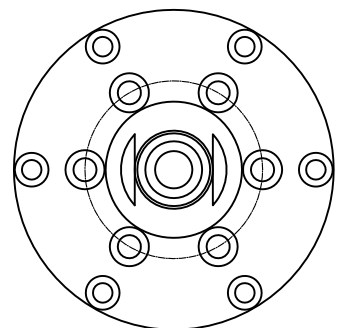
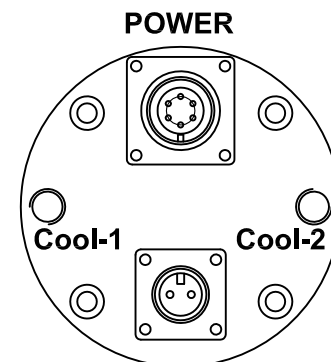

USP -Power

Ultrasonic connect :

pin1- (+)  
pin2- (-)

Specification	Data
Motor Type	220V,2P,3φ
Power Output	1.5Kw
Maximun Motor Speed	20000 rpm
Maximun Dynamic Run-out	0.01 mm
Cooling Water Flow Rate	70 l/hr
Cooling Water Inlet Temp.	20 c°~ 24 c°
Dimension	φ90 h6
Weight	

Open the machine every day,  
so that the speed of the spindle 0~6000 rpm about 10minutes, slowly accelerated.  
The bearing slowly heating, so that the life of the spindle will be longer

The manufacturer has the power to change the performance and appearance dimensions.  
The change is made to the advanced method of the product.